

Skyline®

Duet™ Banner Stand Set-Up

1-800-328-2725

www.skyline.com

©2009 Skyline Exhibits

PN32450-A

1. Assemble Shock-Corded Poles.

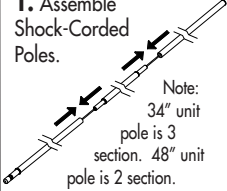

2. Turn foot 90°.

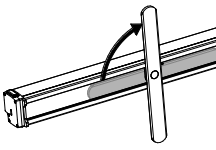

3. Fit Poles into sockets of base.

Press down until pole clicks into place.

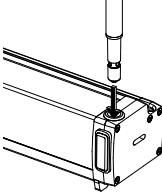

4. Lift Banner Support Bar from base and insert ends into tops of poles.

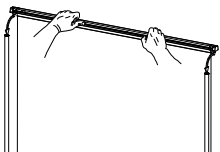

To Disassemble - Reverse set-up procedure.

When retracting banner, lower it slowly and keep it centered.

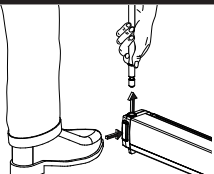

Note: To release poles during takedown, tap on the button with foot while pulling up on pole.